

GLORY

Revolution
Retail Systems

PARAGON™ SERIES



Paragon 3SE/4SE Dual - 3LW/4LW Dual

PARAGON™ SERIES



Paragon 3SE/4SE Dual



Paragon 3LW/4LW Dual

HARDWARE FEATURES:

- Closed loop architecture of notes and coins; no manual intervention required
- Coin discrimination (i.e. counterfeit coin rejection)
- Scalable – up to two (2) note recyclers
- Lockable deposit cassette
- “Fitness sort” on recycled notes
- Flexible note orientation (no need to separate or face notes)
- Pocket note acceptor (handles large bundles of notes; up to 200)
- Integrated drop/storage vault – optional
- Dispenses coins directly into till tray – Paragon 3SE & 4SE
- Dispenses coins directly into till drawer – Paragon 3LW & 4LW
- Optional biometrics (fingerprint reader)
- Cup LEDs (notification if change is left in cups)
- Scalable platform
- Continuous 24/7 monitoring
- Integrated printer
- Vault - UL 291 business hours rated

FEATURE CAPABILITY:

- Ability to integrate with pos system
- Same day credit on deposit (provisional credit)

ACCESS/CONTROL:

- Drops can be made via a drop chute
- The drop vault is controlled by biometric access
- Till drawers, packages, or drops can be tracked by barcode scanner in conjunction with RRS Paragon Series

SOFTWARE FEATURES:

- PCI compliant
- REACH™ remote monitoring solutions for tech support
- Real time cash/coin level monitoring
- Scalable – cluster format
- Reporting – standard or custom
- Lane and/or clerk accountability
- Tills and drop bags automatically traced to a specific user by utilizing bar-coding
- Multiple tills per register/lane
- Configurable user permission levels for machine access
- Multiple user authentication schemes (log-in and pin, or biometrics)
- Automatic prompting of periodic password changes
- Track monies outside of unit with external vault fund function
- Guided deposit preparation: automatically calculates and moves deposit to courier cassette
- Automatic end of day reporting
- Courier specific log-in menu
- Video troubleshooting tips
- Video guidance for system operation

DROP VAULT:

- Height: 43.8”
- Width: 7.79”
- Weight: 225 lbs.
- Available volume: 1.83 cubic feet

ELECTRICAL RATINGS:

- 100-130 V
- 50/60 Hz
- 9A

GLORY

Revolution
Retail Systems

PARAGON™ SERIES

SPECIFICATIONS

Physical Characteristics (nominal):	Paragon 3SE Dual	Paragon 3LW Dual	Paragon 4SE Dual	Paragon 4LW Dual
Height	48.78" (1,239.1 mm)	50.73" (1,288.5 mm)	48.78" (1,239.1 mm)	50.73" (1,288.5 mm)
Width	63.32" (1,582.9 mm)	72.58" (1,843.5 mm)	63.32" (1,582.9 mm)	72.58" (1,843.5 mm)
Depth (install depth)	36.64" (930.6 mm)	36.64" (930.6 mm)	36.64" (930.6 mm)	36.64" (930.6 mm)
Weight (empty)	2,900 lbs. (1,315 kg)	3,000 lbs. (1,361 kg)	2,900 lbs. (1,315 kg)	3,000 lbs. (1,361 kg)
Device Configuration:				
Number of Recycling Cassettes	6	6	8	8
Number of Deposit Cassettes	2	2	2	2
Notes:				
Capacity per Cassette (approximate):				
Recycle Cassette	2,700 notes	2,700 notes	2,700 notes	2,700 notes
Deposit Cassette	2,700 notes	2,700 notes	2,700 notes	2,700 notes
Total Capacity of Notes	21,600 notes	21,600 notes	27,000 notes	27,000 notes
Processing Speed In or Out (max)	8 notes/sec	8 notes/sec	8 notes/sec	8 notes/sec
Recycling Capability (max)	(6) denominations	(6) denominations	(8) denominations	(8) denominations
Coin:				
Number of Recycle Modules	4	4	4	4
Capacity by Denomination (maximum):				
• Pennies	4,300	10,000+	4,300	10,000+
• Nickels	2,900	6,000+	2,900	6,000+
• Dimes	6,100	13,500+	6,100	13,500+
• Quarters	2,350	5,000+	2,350	5,000+
• Fifty Cent Piece	20	200	20	200
• Dollar	130	800	130	800
• Sorted Overflow	---	24,000	---	24,000
Total Coin Capacity	15,800	59,500+	15,800	59,500+
Coin Processing Speed In (up to)	700 coin/min	3,000 coin/min	700 coin/min	3,000 coin/min
Coin processing Speed Out (up to)	16 coin/sec	32 coin/sec	16 coin/sec	32 coin/sec
Accepts Up To	(6) denominations	(6) denominations	(6) denominations	(6) denominations
Recycle Up To	(4) denominations	(4) denominations	(4) denominations	(4) denominations

GLORY

Revolution
Retail Systems

PARAGON™ SERIES

PARAGON 3SE DUAL / PARAGON 4SE DUAL

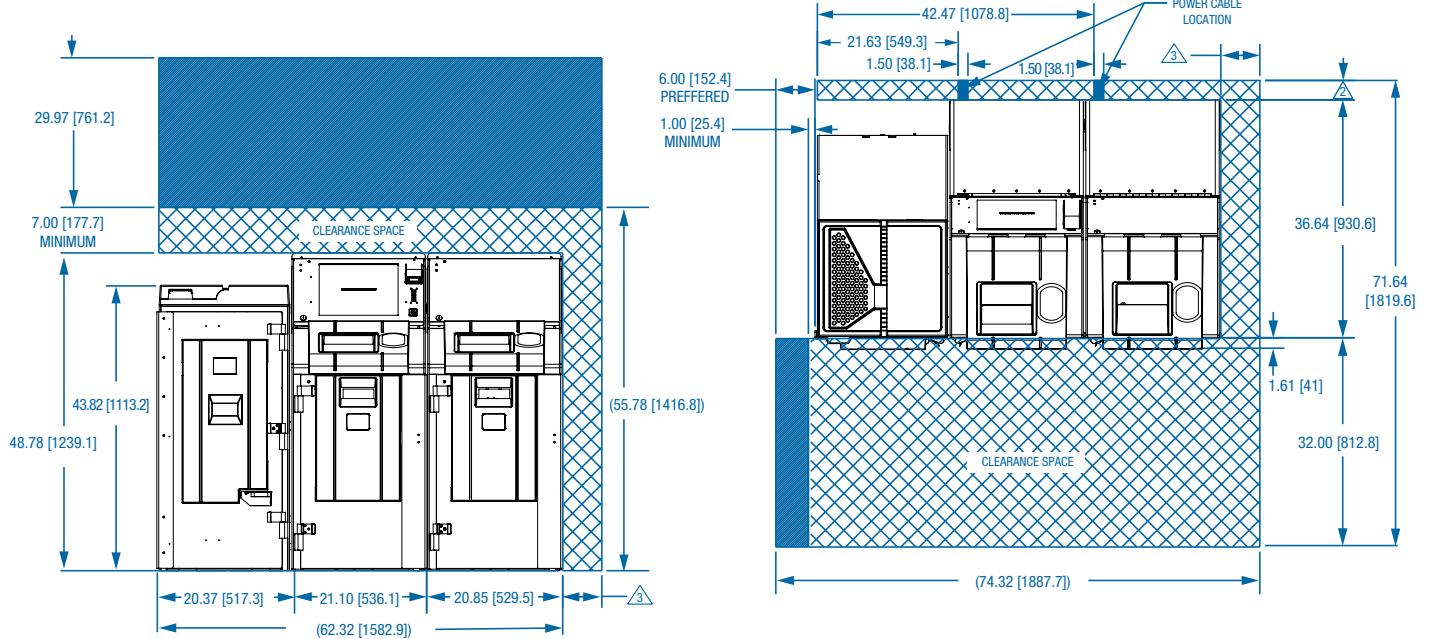

PARAGON 3LW DUAL / PARAGON 4LW DUAL

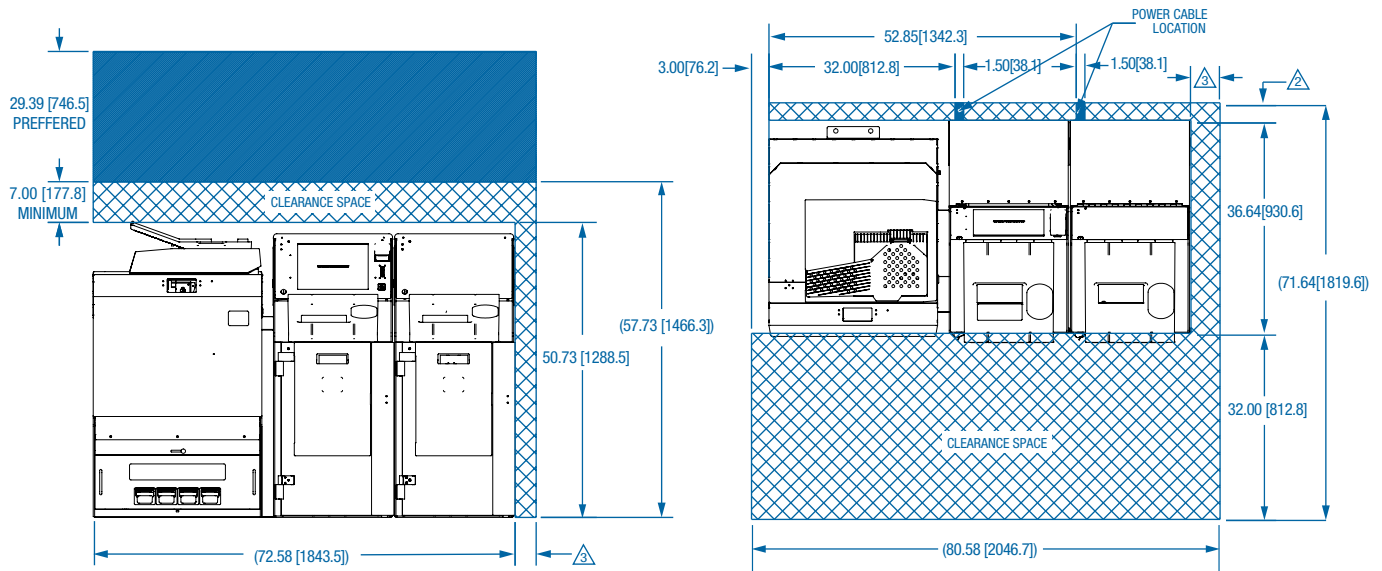

- 1 SYSTEM MUST BE SECURED TO LEVEL FLOOR.
- 2 IF THE A/C OUTLET IS NOT LOCATED IN THE INDICATED AREA BEHIND THE UNIT, THIS DIMENSION TO BE A MINIMUM OF 3".
IF THE A/C OUTLET IS LOCATED IN THE INDICATED AREA BEHIND THE UNIT, THIS DIMENSION TO BE A MINIMUM OF 5".
- 3 IF UPS/AC DISTRIBUTION BOX POWER SWITCH IS ON THE LEFT SIDE OF THE MACHINE, THIS DIMENSION CAN BE MINIMUM 1.00 [25.4]
OTHERWISE THIS DIMENSION IS MINIMUM 6.00 [152.4].

GLORY

Revolution
Retail Systems