

Revolution Retail Systems

FORTIS™ SERIES



Notes





SPECIFICATIONS: Fortis Notes

Height: 60.24" (1530.07 mm)

Width: 20.58" (522.82 mm)

Depth: 41.12" (1044.47 mm)

Weight: 1,400 lbs. (635 kg)

*Unit must be secured to a level floor.

Device Configuration:

- Number of Recycle Cassettes (Standard) *Optional-Number of Recycle Cassettes (Small)
- Number of deposit cassettes

Fortis 4

4
8
1

Notes:

Capacity per cassette (approx.):

- Standard Recycle cassette 3,000 notes
 - Small Recycle cassette 800 notes
 - Deposit Cassette 7,200 notes
 - Roll storage 500 notes
- Total capacity of notes 19,200 notes

Processing:

Bulk Note Acceptor

Note processing speed in/out

Recycle up to

8 notes/sec

(4) Denominations (standard)

(8) Denominations (optional)

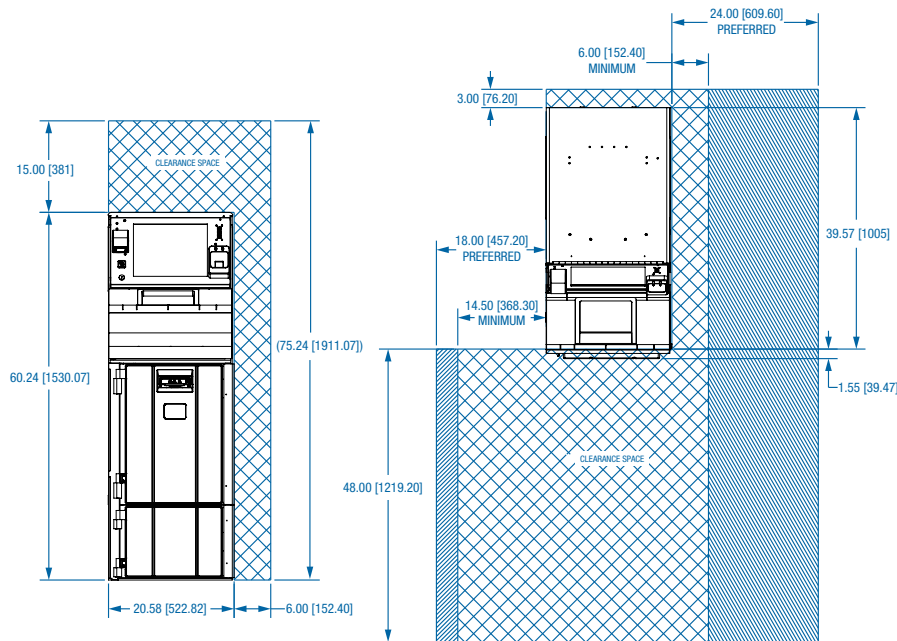

HARDWARE FEATURES:

- Closed Loop Architecture of Notes; No Manual Intervention Required
- Lockable Deposit Cassette
- "Fitness Sort" on Recycled Notes
- Flexible Note Orientation (No Need to Separate or Face Notes)
- Pocket Note Acceptor Handles Large Bundles of Notes
- Scalable Platform
- Continuous 24/7 Monitoring
- Integrated Printer
- Integrated Till Check In/Out Scanner – Optional
- Integrated Palm Scanner Biometrics – Optional
- Uninterruptable Power Supply

SOFTWARE FEATURES:

- PCI Compliant
- Axeda Remote Monitoring Solutions for Tech Support
- Real Time Cash/Coin Level Monitoring
- Scalable – Cluster Format
- Reporting – Standard or Custom
- Lane and/or Clerk Accountability
- Tills and Drop Bags Automatically Traced to a Specific User by Utilizing Bar-Coding
- Multiple Tills per Register/Lane
- Configurable User Permission Levels for Machine Access
- Multiple User Authentication Schemes (Card & PIN, Log-in and PIN, or Biometrics)
- Automatic Prompting of Periodic Password Changes
- Customized Programming of ID Cards
- Track Monies outside of Unit with External Vault Fund Function
- Guided Deposit Preparation: Automatically Calculates and Moves Deposit to Courier Cassette
- Automatic End of Day Reporting
- Courier Specific Log-In Menu
- Video Troubleshooting Tips
- Video Guidance for System Operation

FEATURE CAPABILITY:

- Ability to Integrate with POS System
- Same Day Credit on Deposit (Provisional Credit)